

CHARMILL

RESIDENTIAL



Stuart Tower, Maida Vale W9
£499,950 Share of Freehold



A well presented one bedroom apartment situated on the third floor (with lift) of this well maintained purpose-built block in Maida Vale. The property comprises a semi open plan fitted kitchen/reception room with wooden flooring which leads out to a private south-west facing balcony, a spacious double bedroom and a fully tiled shower room. The apartment further benefits from ample storage space and a 24 hour porter.

Stuart Tower is ideally located within walking distance of Regents Canal, local shops, restaurants and cafes on Clifton Road together with Maida Vale and Warwick Avenue stations (Bakerloo line) being 0.3 miles and 0.4 miles away respectively. Paddington station is also within easy reach, offering Circle, District, Bakerloo and Hammersmith & City lines together with National Rail services and the Heathrow Express providing access to Heathrow Airport in 15 minutes as well as the new Elizabeth line connecting you to Canary Wharf in just 18 minutes.



SILVER TOWER

HANLEY ROAD

Floor Plan

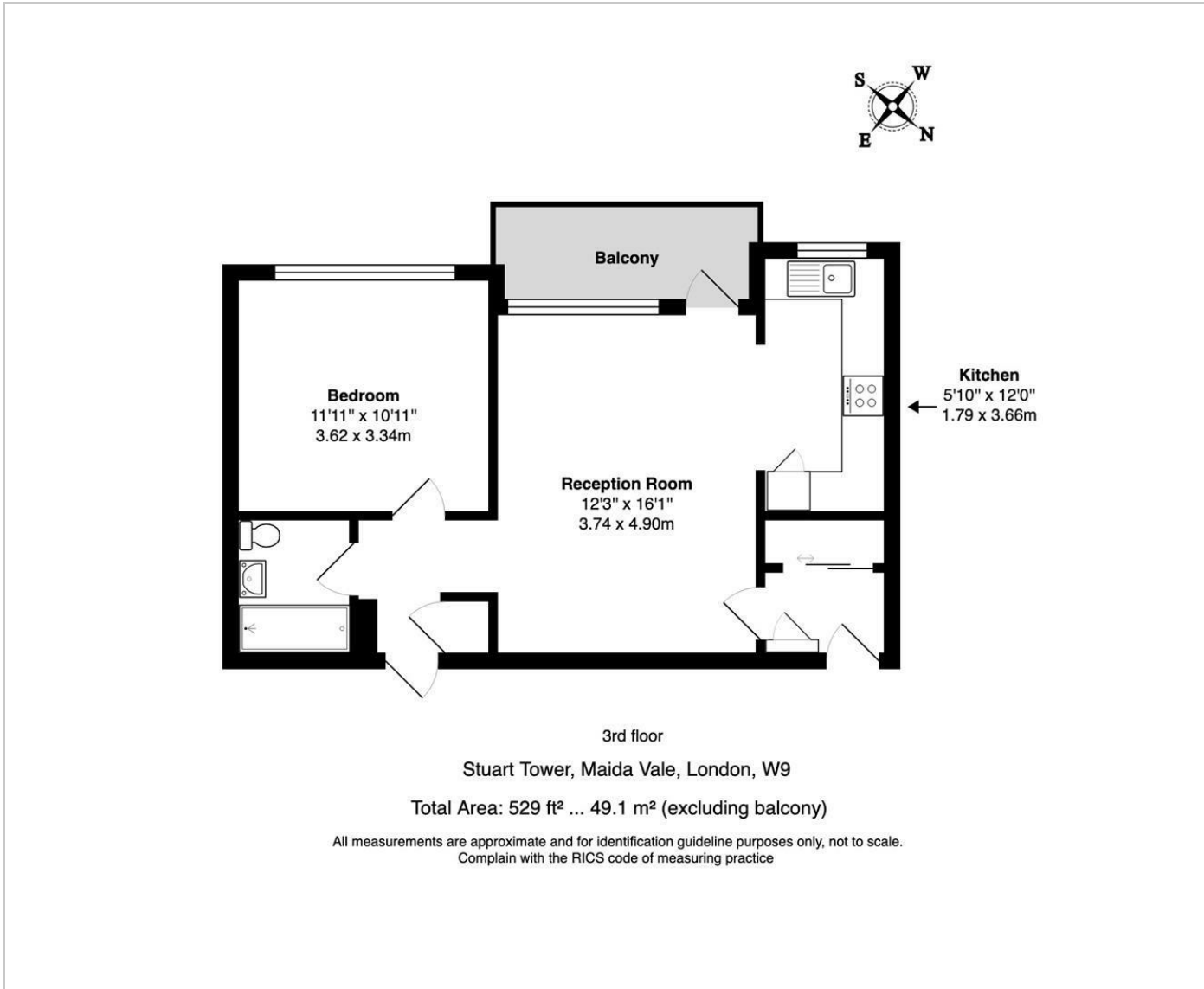

Area Map

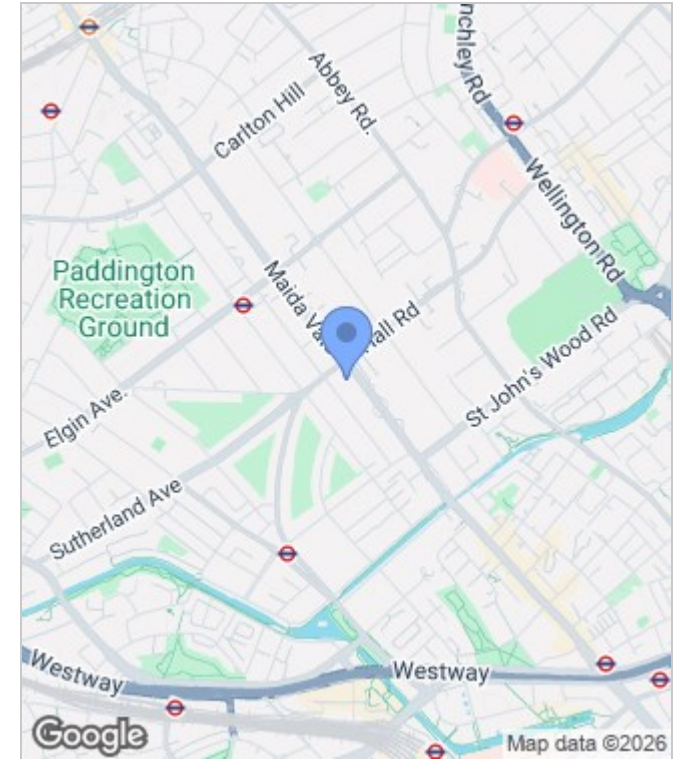

Energy Performance Graph

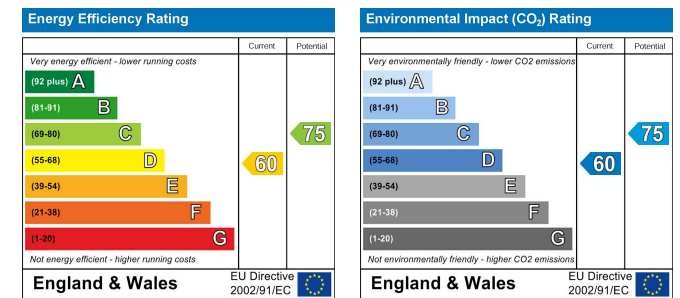

These particulars, whilst believed to be accurate are set out as a general outline only for guidance and do not constitute any part of an offer or contract. Intending purchasers should not rely on them as statements of representation of fact, but must satisfy themselves by inspection or otherwise as to their accuracy. No person in this firm's employment has the authority to make or give any representation or warranty in respect of the property.

